



1997

## An Assessment of Prehistoric Sites 41CP228 and 41CP229 Camp County, Texas

Glenn T. Goode

Follow this and additional works at: <https://scholarworks.sfasu.edu/ita>



Part of the [American Material Culture Commons](#), [Archaeological Anthropology Commons](#), [Cultural Resource Management and Policy Analysis Commons](#), [Historic Preservation and Conservation Commons](#), [History Commons](#), [Human Geography Commons](#), [Other Anthropology Commons](#), [Other Arts and Humanities Commons](#), [Other History of Art, Architecture, and Archaeology Commons](#), [Other Social and Behavioral Sciences Commons](#), and the [Technical and Professional Writing Commons](#)

Tell us how this article helped you.

---

### Repository Citation

Goode, Glenn T. (1997) "An Assessment of Prehistoric Sites 41CP228 and 41CP229 Camp County, Texas," *Index of Texas Archaeology: Open Access Gray Literature from the Lone Star State*: Vol. 1997 , Article 21. <https://doi.org/10.21112/ita.1997.1.21>

ISSN: 2475-9333

Available at: <https://scholarworks.sfasu.edu/ita/vol1997/iss1/21>

This Article is brought to you for free and open access by the Center for Regional Heritage Research at SFA ScholarWorks. It has been accepted for inclusion in Index of Texas Archaeology: Open Access Gray Literature from the Lone Star State by an authorized editor of SFA ScholarWorks. For more information, please contact [cdsscholarworks@sfasu.edu](mailto:cdsscholarworks@sfasu.edu).

---

## An Assessment of Prehistoric Sites 41CP228 and 41CP229 Camp County, Texas

### Licensing Statement

This is a work produced for the Texas Department of Transportation (TxDOT) by the report producer. TxDOT and the report producer jointly own all rights, title, and interest in and to all intellectual property developed under TxDOT's contract with the report producer. The report may be cited and brief passages from this publication may be reproduced without permission provided that credit is given to both TxDOT and the report producer. Permission to reprint an entire chapter, section, figures or tables must be obtained in advance from either the Supervisor of the Archeological Studies Branch, Environmental Affairs Division, Texas Department of Transportation, 125 East 11th Street, Austin, Texas, 78701 or from the report producer.

**An Assessment of Prehistoric Sites  
41CP228 and 41CP229  
Camp County, Texas**

**By**

**Glenn T. Goode**

**September 1997**

**Archeology Studies Program  
Cultural Resource Management Section  
Environmental Affairs Division  
Texas Department of Transportation**

# TABLE OF CONTENTS

Introduction .....	1
Environmental Background .....	1
Archeological Background .....	1
Methodology For Assessment of 41CP229 .....	5
Gradall Trenches .....	5
Hand Excavations .....	5
Anomalies and Possible Cultural Features .....	5
Soils .....	8
Artifact Assemblage .....	9
Debitage Analysis .....	9
Types of Knapping Tools .....	9
Cortex .....	9
Material Type .....	12
Diagnostic Artifacts, Biface Fragments, and Other Tools .....	12
Other Chipped Stone Artifacts .....	12
Ground Stone .....	12
Excavations at 41CP228 .....	14
Assessment and Recommendations .....	17
References Cited .....	19

## LIST OF FIGURES

Figure 1: Site location in Camp County.....	2
Figure 2: Site location on topographic map .....	3
Figure 3: Location of Gradall trenches and shovel tests at 41CP229.....	4
Figure 4: Feature 1 .....	7
Figure 5: Selected artifacts from 4 ICP229.....	11
Figure 6: Location of Gradall trenches and shovel tests at 41 CP228.....	15

## LIST OF TABLES

Table 1: Dimensions of Gradall trenches and test pits .....	6
Table 2: Distribution of Lithic Debitage (flakes) at 41CP229.....	10
Table 3: Distribution of tools from shovel tests at 41 CP229.....	<b>13</b>
Table 4: Artifact distribution in Gradall trenches at 41 CP229 .....	<b>13</b>
Table 5: Dimensions of Gradall trenches and test pit.....	14

## INTRODUCTION

The road along which sites 41CP228 and 229 occur is F.M. 1520 (Fig. 1 and Fig. 2), with the limits of improvements to it being from 0.8 mi. north of Loop 179 to 0.7 mi. north of Walkers Creek--a length of approximately 1.25 miles. This is a particularly dangerous stretch of roadway with curves at Walkers Creek and its tributary to the north. Along this stretch in recent years several people have died in automobile accidents, most recently during the course of the fieldwork in September, 1996. The proposed work will realign the roadway to eliminate the curves, and construct two new multiple box culverts.

An assessment of these prehistoric sites was conducted between September 3 and September 18, 1996, but a total of only 7 days was spent in the field. The sites were recorded in 1993, with shovel testing done at both and recommendations made for further work. From 39 shovel tests at 41CP229, a total of 5 artifacts was found and the site was recommended for test excavation. In an area near site 41CP228, no artifacts were found in 17 shovel tests and the site appeared to be outside the right-of-way; however, it was recommended that monitoring should be done during construction.

The purpose of the recent work was to determine if the part of site 41CP229 in the proposed right-of-way warranted formal test excavation, and if site 41CP228 extended into the right-of-way. This evaluation of the sites was done with a combination of Gradall scraping and hand excavation of large shovel tests. The emphasis of the work at 41CP229 was on finding features such as house patterns in the relatively shallow sandy deposit and underlying clay.

## ENVIRONMENTAL BACKGROUND

Camp County and the surrounding region occur within the West Gulf Coastal Plain portion of the Coastal Plain Physiographic Province (Sellards, et al, 1932). The region is underlain by various formations of the Eocene-age Claiborne Group, including the Carrizo Sand, the Reklaw Formation, the Queen City Formation, and the Wilcox Group (Bureau of Economic Geology). The present project, which is not very long, appears to lie entirely upon the Carrizo Sand.

The region's topography is mostly rolling to hilly, with occasional flat areas along divides and floodplains. Dominated by oak-hickory-pine forests, the Camp County

region lies within, although fairly near the western margin of, the Austroriparian Biotic Province (Blair 1950), which extends eastward to the Atlantic.

This part of Texas has a humid subtropical climate characterized by hot summers and mild winters (Carr 1967). As in most regions of the state, the greatest rainfall occurs in late spring and early fall, the mean annual amount being about 44 inches.

## ARCHEOLOGICAL BACKGROUND

The cultural chronology of northeast Texas, much as the surrounding regions, is usually presented as a scheme of four periods of stages. As described by Story (1981), these are: Paleoindian (ca. 10,000 to 6000 B.C.); Archaic (ca. 6000 to 200 B.C.); Early Ceramic (ca. 200 B.C. to A.D. 800); and Late Prehistoric (ca. A.D. 800 to 1600).

Both the earlier (Clovis) and later (Dalton, San Patrice, Scottsbluff) manifestations of the Paleoindian Stage are found either in the whole of east Texas, or in the northeastern portion that includes Camp County.

The Archaic Stage is often discussed in terms of three periods (Early, Middle, Late) of approximately 2000 years each. Some of the major temporal indicators of the Archaic are known by type names such as Johnson, Calf Creek, Wells, Morrill, Trinity, Yarbrough, Gary, and Kent. The Gary and Kent types, at least, persist into the Early Ceramic period which is better recognized by ceramics such as Williams Plain, and types of the Marksville and Troyville cultures. Arrowpoint types of the period, such as Friley and Colbert, have expanding stems.

Around A.D. 800, the Formative Caddoan period was developing, and was then followed by the Early, Middle, Late, and Historic Caddoan periods. The Coles Creek culture, though weakly represented this far west, perhaps also made its appearance in northeastern Texas in the 9th century at sites on down the Big Cypress and elsewhere.

Previous work in the vicinity includes TxDOT's excavation of the Tankersley Creek Site (Young 1981) across the Big Cypress in Titus County. A good variety of Archaic, as well as Early Ceramic and Caddoan materials, was recovered from this site.

At nearby Lake Bob Sandlin on the Big Cypress, minor excavations conducted in the 1970s produced mostly Late Archaic and Caddoan materials (T.K. Perttula, personal communication 1996).

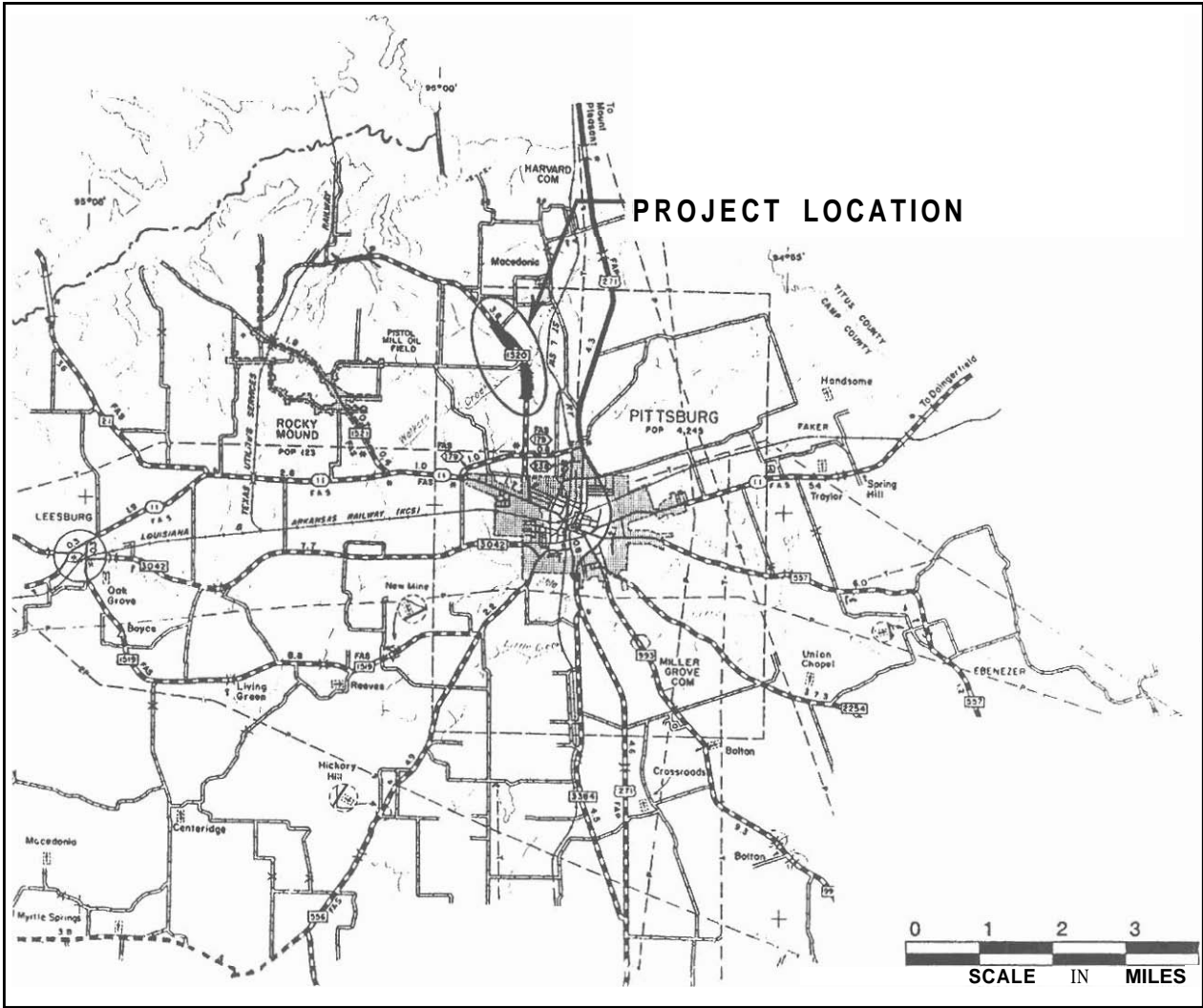

Figure 1: Site location in Camp County.

This Page Redacted Per THC Policy



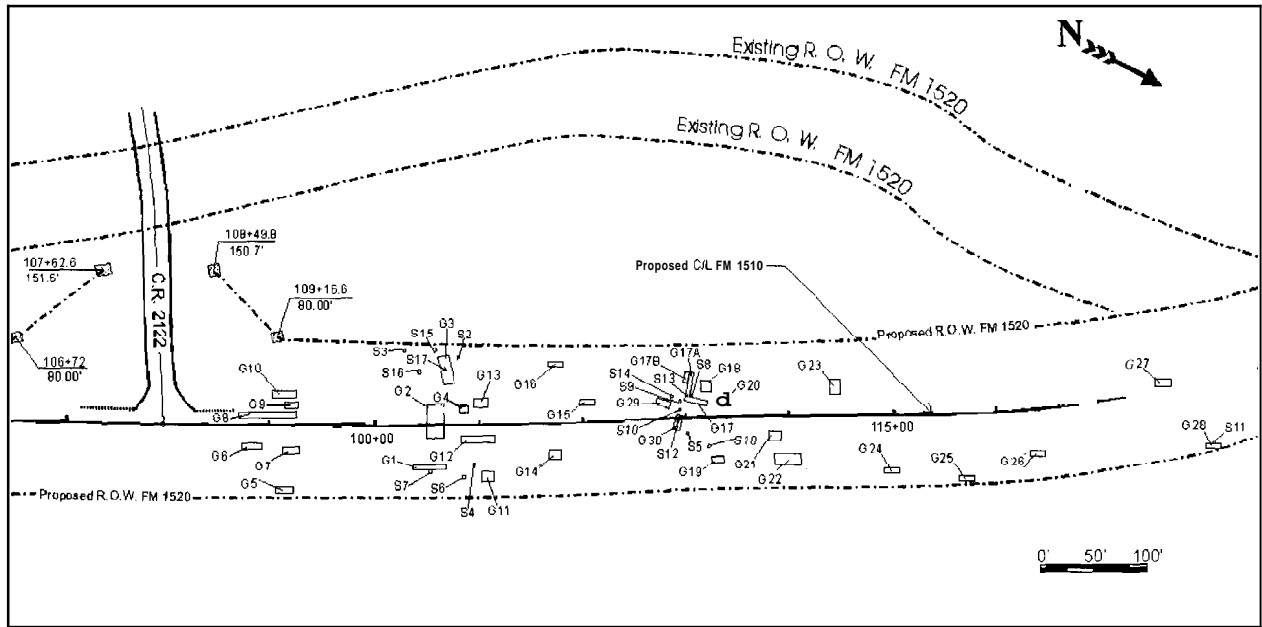

Figure 3: Location of Gradall trenches and shovel tests at 41CP229.

## METHODOLOGY FOR ASSESSMENT OF 41CP229

Because site 41CP229 will be bisected by the proposed right-of-way of 160 ft. width, considerably more work was done at this location than at site 41CP228, which is outside the right-of-way. This work (Fig. 3) amounted to a total of 30 Gradall scrapes and trenches of various sizes, and 17 shovel tests, also of variable size (Table 1). The portion of site 41CP229 within the proposed right-of-way is within a hay meadow that has been farmed for many years. Though the hay had been recently mown and baled, there remained a cover sufficiently dense to obscure most of the ground surface. Therefore, no effort was made to find surficial concentrations of cultural material for the purpose of placing excavations.

The rationale behind the placement of excavations was an effort to sample reasonably well the various areas of the site, such as the terrace margin, slope, and ridgetop. Several shovel tests were placed in what were judged to be likely places to find prehistoric materials, while others were placed within or adjacent to gradall scrapes following the finding of anomalies. The hand excavations, called shovel tests, were done in a more-or-less standard fashion, using the usual equipment. All of the matrix was screened through 1/4 in. hardware cloth, with the return placed in labeled paper bags. Level floors were shovel shaved or troweled in an effort to find features.

### GRADALL TRENCHES

The proposed route for the relocation of FM 1520 will cut a swath through site 41CP229 that is approximately 800 ft. long and 160 ft. wide (Fig. 3). For an area of this size, it was thought best to use a Gradall to quickly reveal the site's stratigraphy and contents. Although a relatively large number of Gradall trenches (GT) and scrapes was dug, the area exposed was only a fraction of the site area within the right-of-way. The area opened, though, is considered to be a representative sample of the site and sufficient for making predictions and recommendations.

There were three areas in which Gradall trenches and scrapes were concentrated (see Figure 3), one on the slope between the floodplain and the terrace margin (6 trenches between Centerline Station (CS) 108 and 110), one on the flatter part of the terrace north of its margin (7 trenches between CS 110 and CS 111), and another between CS 112 and 114. The remainder of the 30 Gradall trenches were more widely scattered up the gentle rise to the apex of the low ridge dividing Walkers Creek and its tributary to the north. The trenches ranged from 2 m to 16 m in length, and from 1.8 m to 9.1 m in width. A majority of the trenches were between 4 and 5 m long, with 4 being longer than 10

m and 4 shorter than 4 m. As a whole, this site was quite shallow and only one trench was more than a meter deep.

### HAND EXCAVATIONS

Inasmuch as the part of site 41CP229 to be impacted by road construction is quite large, as previously noted, a relatively large number of hand excavations was also needed to get a good picture of the site's contents. Because this assessment of sites 41CP228 and 229 was not approached as a full-scale test excavation, the hand excavations are called shovel tests instead of test pits. There were 17 of them (Fig. 3) and they were concentrated in two areas: along the terrace margin, and in the vicinity of Gradall Trench 17 where an anthropogenic (but recent) feature was uncovered. Only one shovel test was dug north of this area, beside GT 28 at CS 118.

Although these excavations were not called test pits, they nevertheless were treated much the same, being for the most part rather precisely dug squares ranging in size from 50 X 50 cm to 1 X 1 m (Table 1). Excavation increments were 10 cm and leveled floors often were cleaned and checked for features.

### ANOMALIES AND POSSIBLE CULTURAL FEATURES

Close monitoring of the Gradall excavations was also done in an effort to find features, and several anomalies or disturbances were uncovered, most of which could be easily attributed to 20th century activity and bioturbation. Of the anomalies, two were possibly prehistoric, but they could not be linked to any other features or cultural material. One of these is an irregular pit (90 X 225 cm), labeled Feature 1 (Fig. 4), that was dug into the clay substrate. It was found by Gradall stripping, at a depth of 20-25 cm below ground surface in Gradall Trench 3. Feature 1 had an average depth of about 30 cm, though it is likely that its upper portion was removed by the Gradall. It contained fairly discrete areas of darker or lighter sandy matrix, and considerable mixing or mottling of clay, charcoal, ironstone pebbles, and rodent trails. Only two small flakes were found in the screened matrix. Since Feature 1 clearly was not a trash pit, and contained widespread charcoal, it may have been an aboriginal food-preparation pit.

The other possible prehistoric feature resembled a posthole (13 cm in diameter), but only a 10 cm vertical section of it remained and it did not reach the clay

Table 1: Dimensions of Gradall trenches and test pits.

SITE #41CP229				
PIT #	LENGTH	WIDTH	DEPTH	REMARKS
G1	11.6 m	1.8 m	0.9 m	
G2	4.6 m	9.1 m	0.5 m	
G3	4.3 m	7.6 m	0.5 m	N. corner elev. = 349.52' (existing grade)
G4	3.7 m	3.0 m	0.3 m	
G5	4.6 m	1.8 m	0.6 m	
G6	5.2 m	1.8 m	0.9 m	
G7	4.9 m	1.8 m	0.3 m	
G8	15.8 m	1.8 m	1.1 m	
G9	4.3 m	1.8 m	0.3 m <sup>2</sup>	
G10	4.9 m	1.8 m	0.6 m	
G11	4.6 m	3.4 m	0.9 m	
G12	12.2 m	1.8 m	0.6 m	
G13	4.6 m	3.7 m	0.3 m	
G14	4.6 m	1.8 m	0.3 m	
G15	4.6 m	1.8 m	0.6 m	
G16	4.6 m	1.8 m	0.6 m	
G17	8.8 m	1.8 m	0.9 m	SW corner elev. = 352.74' (existing grade)
G17A	1.8 m	9.1 m	0.9 m	
G17B	3.7 m	4.3 m	0.9 m	
G18	4.6 m	5.2 m	0.6 m	
G19	4.3 m	1.8 m	0.8 m	
G20	4.9 m	3.4 m	0.5 m	
G21	4.6 m	3.7 m	0.6 m	
G22	10.0 m	5.5 m	0.6 m	
G23	4.6 m	5.5 m	0.5 m	
G24	4.6 m	1.8 m	0.6 m	
G25	4.9 m	1.8 m	0.5 m	
G26	4.9 m	1.8 m	0.3 m	
G27	4.6 m	1.8 m	0.5 m	
G28	4.6 m	1.8 m	0.6 m	
G29	4.6 m	1.8 m	0.6 m	
G30	1.8 m	3.7 m	0.6 m	
S1	0.5 m	0.5 m	0.5 m	
S2	1.0 m	1.0 m	0.3 m	
S3	0.5 m	0.5 m	0.3 m	
S4	0.8 m	0.8 m	0.9 m	
S5	0.5 m	0.5 m	0.5 m	
S6	1.0 m	1.0 m	0.9 m	
S7	0.5 m	1.0 m	0.9 m	
S8	0.75 m	0.75 m	0.7 m	
S9	0.5 m	0.5 m	0.6 m	
S10	0.5 m	0.5 m	0.6 m	
S11	0.5 m	0.5 m	0.5 m	
S12	0.5 m	0.5 m	0.5 m	
S13	0.75 m	0.75 m	0.3 m	
S14	0.5 m	0.5 m	0.5 m	
S15	1.0 m	1.0 m	0.2 m	
S16	1.0 m	1.0 m	0.4 m	
S17	1.0 m	0.6 m	0.3 m	

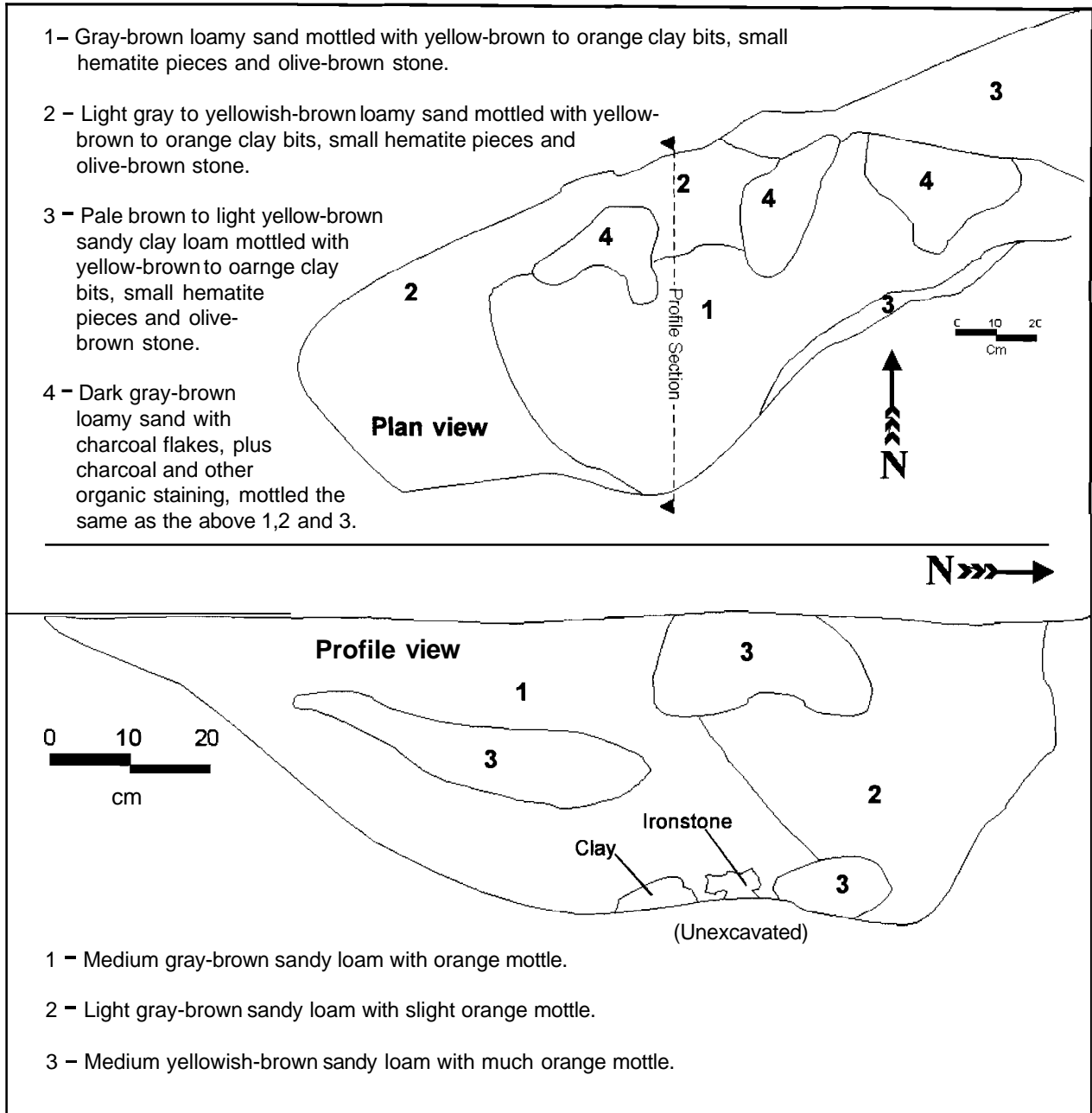

Figure 4: Feature 1.

substrate. After a fairly large area had been stripped, this anomaly still stood alone, so it seems more likely to have been a recent than a prehistoric disturbance.

Among the anomalies was an anthropogenic feature that at first could not be proven to be prehistoric or recent, though it was suspected to be the latter. In Gradall Trench 17, it occurred as a thin (5-10 cm) lens of dark gray sandy loam, containing charcoal flecks, and being 35 to 45 cm below the ground surface. Expanded excavation around GT 17 demonstrated the 20th century affiliation of this feature, or disturbance. It appears to be a recent surface (O/A horizon) where brush apparently was piled and burned. The area was then deep plowed and a large terrace was constructed mostly of sand stripped from nearby parts of the field. The terrace lies upon the burned area, thus preserving it under 20 to 35 cm of sandy matrix.

It is possible, of course, that cultural features were missed, given the comparatively minor amount of excavation within a large area. However, the sparse artifactual recovery, coupled with a failure to identify more than one cultural feature from numerous excavations, reduces the likelihood that significant features were missed.

## SOILS

The excavations at 4ICP229 exposed a relatively shallow mantle of sand over most of the terrace (or bench) and upper slope that contains cultural material. In this location, high above Walkers Creek, the sandy deposit is of colluvial and aeolian origin. For the most part, the sandy deposit is about 30 cm in thickness, but in places it is thinner or thicker due to terracing of the field. Only in one small area, along the east right-of-way between CS 110 and 111, was the sandy deposit greater, being up to 90 cm in thickness. Everywhere the sandy mantle was underlain by sandy clay, of varying colors, and, below the terrace margin, by red clay and massive deposits of ferruginous sandstone which had previously served as a gravel source.

The Bowie fine sandy loam is the major soil of the project area, with the Luka fine sandy loam occurring along the floodplain of Walkers Creek (Soil Survey of Camp County).

## ARTIFACT ASSEMBLAGE

With the exception of two sherds of prehistoric ceramics, the artifacts recovered from 41CP229 are made of stone. The majority of these are chipped-stone debitage and tools from siliceous stones such as flint and quartzite, with a few ground stone tools completing the sample. Typical of the region, the sample of chipped-stone debitage is composed predominately of small flakes. The ratio of tools and manufacture failures to debitage seems to be on the low side, but this may not be the case in the richer (more dart points) part of the site, which reportedly is 100 m or more to the east.

The total of flakes and fragments collected from the excavations is 188 specimens (Table 2). All but three of these are from the 17 shovel tests; two others are from Feature 1 and another is from GT 1. A few additional flakes and one small unfinished biface were collected from the area of GT 1-4, after the holes had been filled and the backdirt washed by rains. These specimens are housed in the Atlanta District Office where they can be used as a comparative collection.

While most of the site produced extremely low numbers of artifacts from a shallow sandy deposit, one relatively small area along the terrace margin had a deeper deposit (approx. 90 cm) as well as a higher average artifact count per level. Gradall Trench I and ST 1, 4, 6, & 7 were placed in this area.

### DEBITAGE ANALYSIS

The lithic debitage has been analyzed briefly to get a general understanding of stone tool manufacture at 41CP229. In this analysis, several of the more meaningful criteria were considered, but others that have sometimes been useful were not thought appropriate for this small sample. The criteria that were used are: (1) Type of Knapping Tool, (2) Cortex, (3) Material Type, and (4) Size.

To identify some of the knapping tools used at the site, the following variables were employed: Hard Hammer, Soft Hammer, Undetermined Method, and Fragment. To learn about material sources, stages of reduction and where they were performed, the variable Cortex was used, but only its presence or absence on a given specimen was recorded. Identifying Material Type is important for assessing sources of raw material, with implications for such issues as trade and mobility. The Size of raw material bears on such problems as distance to raw material sources, reduction stages, and the kinds of tools being made.

Often, all of these variables are interrelated and the most complete picture of tool making comes from

considering them together. In the case of site 41CP229 the debitage is dominated by flakes from final stage reduction and rejuvenation of mostly small bifaces made of local materials.

### TYPES OF KNAPPING TOOLS

The kinds of knapping tools that could be identified from the debitage are the standard percussors, but the debitage of other standard kinds such as pressure tools was either missing or not obvious. Of the total of 188 flakes, 97 specimens, or 52 percent, retained the platform necessary for identification. Of these, the great majority, or 81 specimens (84 percent), had features typical of soft hammer percussion. Only 7 specimens (7 percent) had features usually seen on hard hammer flakes, with the balance of 9 specimens (9 percent) lacking definitive characteristics (Undetermined Method).

Provided that this interpretation of the debitage is reasonably accurate, a preponderance of the flintknapping done within the project area was done with small soft hammers, or billets. The small size and generally cortex-free condition of the flakes further suggests that the work was mostly final stage manufacture of bifaces, or resharpening of them.

In making claims about the kinds of knapping tools used at a site, it must be recognized that an error factor of 10 percent or more can be expected. Regarding other reduction methods such as pressure and hammer/anvil, the former often was used as much as percussion (most of the tiny flake fragments pass through the screen), while the latter may have been used somewhere on the site.

### CORTEX

Of the total of 188 flakes and fragments, only 28, or 15 percent, had cortex. In the Hard Hammer category, 3 of 7 specimens had cortex, and in the Undetermined Method category 3 of 9 specimens had cortex. In comparison, only 17 of 81 (21 percent) Soft Hammer flakes had cortex, but the former categories are so small that they may not be statistically meaningful. However, these figures do follow a widespread trend in which Soft Hammer flakes have less cortex.

The relatively low percentage of cortex in this sample suggests that little primary reduction was done in this part of the site, and that there was probably not a major raw material source of any kind nearby.

Table 2: Distribution of Lithic Debitage (flakes) at 41CP229.

DEPTH	ST-1 (50x50)	ST-2 (75x75)	ST-3 (50x50)	ST-4 (70x70)	ST-5 (50x50)	ST-6 (1m x 1m)	ST-7 (50x1m)
0-10cm	5	1	2	5	1	8	1
10-20cm	3		1	4	1	14	3
20-30cm	4		1	14	1	12	1
30-40cm	2			10	0	9	0
40-50cm	0			7		1	5
50-60cm				5		5	5
60-70cm				11		7	3
70-80cm				6		3	1
80-90cm				0		0	1
T=163	14	1	4	62	3	59	20

DEPTH	ST-8 (75x75)	ST-9 (50x50)	ST-10 (50x50)	ST-11 (50x50)	ST-12 (50x50)	ST-13 (75x75)	ST-14 (50x50)
0-10cm	0	0	1	0	2		0
10-20cm	0	1	0		0		
20-30cm	0	1	2		1		
30-40cm	2	0	0		0	0	
40-50cm	0						
50-60cm	1						
60-70cm							
T=11	3	2	3	0	3	0	0

DEPTH	ST-15 (1m x 1m)	ST-16 (1m x 1m)	ST-17 (1m x 1m)
0-10cm	2	5	1
10-20cm	0	0	3
20-30cm			0
30-40cm			
T=11	2	5	4

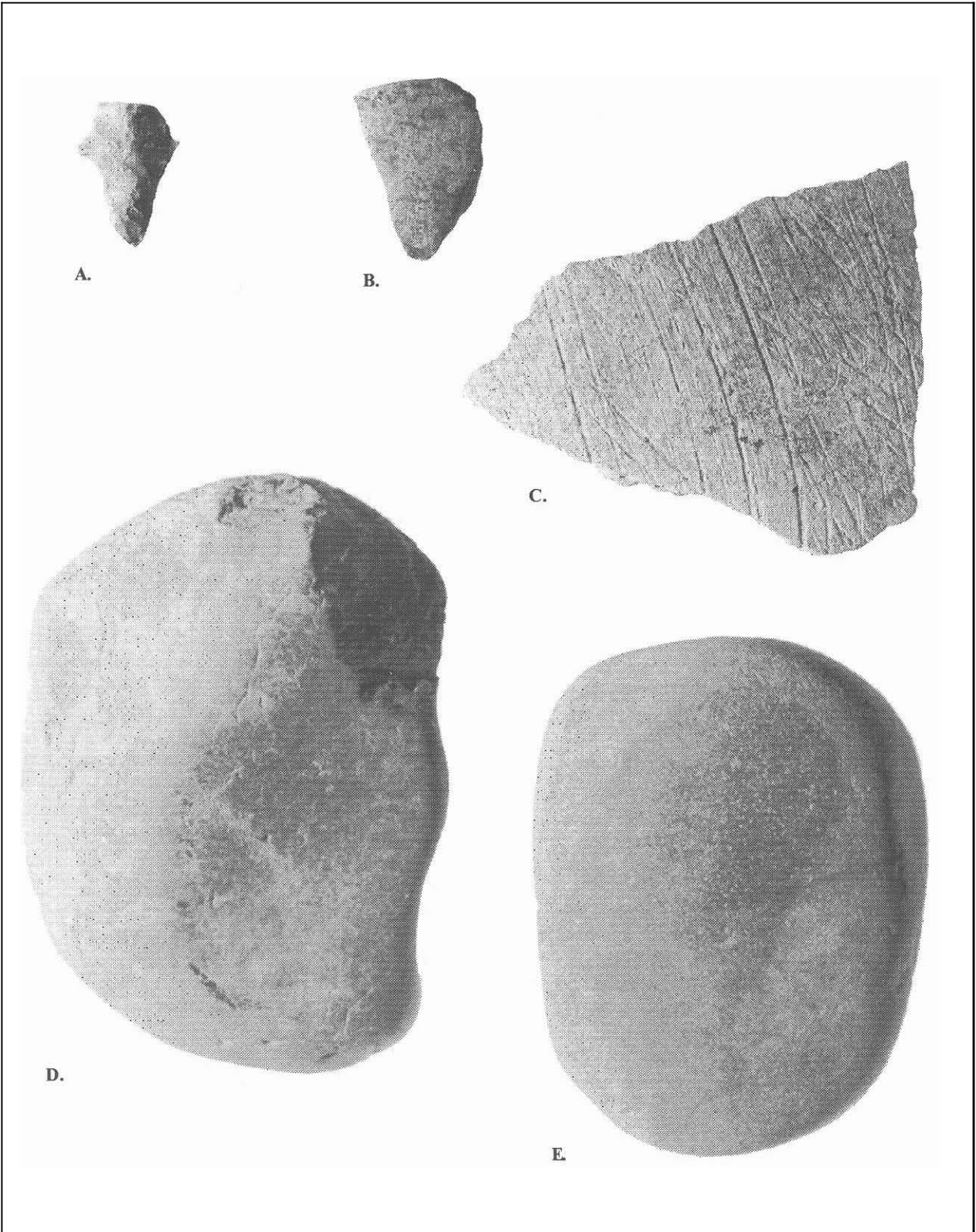

Figure 5: Selected artifacts from 41CP229.



## MATERIAL TYPE

A total of 6 major categories of raw material were identified in the present sample. In order of predominance, these are: (1) fine-grained Ogallala quartzite (Potter chert) - 137, (2) flint - 30, (3) coarse-grained quartzite - 13, (4) claystone/siltstone - 5, (5) chalcedony/novaculite - 2, and (6) silicified wood - 1. With 137 specimens, or 73 percent, the fine-grained Ogallala quartzite is far in the lead. Various kinds of flint, with 30 specimens (16 percent) is a distance second, and the only other material type in double figures. The Ogallala quartzite, some of the flint, the coarse-grained quartzite, claystone, and petrified wood are all local materials; therefore, from these figures it appears that the local knappers relied on local materials (such as Uvalde gravels) for something like 80 to 90 percent of their stone.

Like virtually every assemblage of the region, however, there is a small amount of nonlocal material such as flint, novaculite, and chalcedony from sources such as central Texas, Oklahoma, and Arkansas. And it is not unusual for sites of northeastern Texas to have greater percentages of exotic materials than occur in the present sample.

Only 8 of the 188 flakes and fragments from 41CP229 are larger than 20 mm, so the average specimen is quite small, but not unusually so for assemblages of the region. Of the 8 specimens, 5 are 20-30 mm in length, and 3 are 30-40 mm in length. This sample suggests that raw material of large size was not readily available (a regional phenomenon), and that tools of large size, quite expectedly, were not made in this part of the site (and probably not in any other).

## DIAGNOSTIC ARTIFACTS, BIFACE FRAGMENTS, AND OTHER TOOLS

A total of 11 artifacts that can be classified as tools was recovered from 41CP229 (Table 3), including several pieces broken in manufacture. Of this small sample only three specimens, one dart point and two potsherds, are more or less diagnostic of particular time periods. The dart point is of the ubiquitous Gary type from the Late Archaic and Early Ceramic periods. The sherds cannot be identified as to type, but one may be from the early half of the Caddoan era, while the other is probably from the Middle or Late Caddoan Period.

The small fragmentary Gary dart point (Fig. 5, A) is 25 mm in length, retaining the stem, shoulders, and a small portion of the blade. At the shoulders, it is 17 mm wide and 6 mm thick. It is made of brownish red Ogallala quartzite.

Perhaps the older of the two sherds is a small, undecorated rim fragment (Fig. 5, B). The rim is everted,

rounded, and 4 mm in thickness; maximum thickness of the sherd is 5 mm. The sherd's surfaces are light yellowish brown, with the exterior having a highly worn appearance while the polished interior is better preserved. The paste is dark gray and contains small amounts of bone and grog.

The second specimen is a large body sherd of brushed ware (Fig. 5, C). Its exterior and core are yellowish brown, while the interior is medium brown. The brushing was applied from two directions and overlaps in two areas. Grog is the tempering agent of this well-preserved sherd.

## OTHER CHIPPED STONE ARTIFACTS

Among the chipped stone sample, other tools or worked objects amount to four biface fragments and one modified flake fragment. Only one of the biface fragments is from a completed tool; it is the distal portion of a dart point. All of these specimens are made of Ogallala quartzite. The possible flake tool is the distal section (17 mm long) of a thin Ogallala quartzite flake. It has continuous use damage, in the form of nicking, along two adjoining edges. The edges are rounded and smoothed.

## GROUND STONE

Other tools from the site are ground stone, including a pitted mano, a possible mano (little used), an anvil/metate, a hammerstone, and a pitted stone (Table 4). The two manos came from the terrace margin, one from GT 1 (70 cm deep) and the other from GT 2. The pitted stone is from GT 19 in the central part of the site, while the anvil/metate and hammerstone are from GT 28 along the ridgetop at the site's northern end.

The pitted mano (Fig. 5, E), made of quartzite, has an oblong shape and dimensions of 85 mm long, 65 mm wide, and 44 mm thick; its weight is 399 gm. One face has a shallow, broad depression, or pit, while the other face is generally convex but in the center there is a slight depression that might be an incipient pit. Different parts of this stone's edges have battering or smoothing from other kinds of use.

The other stone that is a possible mano is also a quartzite cobble, of an irregular to oblong shape, being 111 mm in length, 81 mm in width, and 49 mm in thickness; its weight is 572 gm. It has a turtleback shape, with minor smoothing on the flatter but still convex surface. This stone was not used enough to completely smooth the used surface, which retains shallow pitting and unevenness of the original surface.

Perhaps the most significant artifacts from the tested portion of 41CP229 are the two stones found together in GT 28. The larger of the two is a block of ferruginous

sandstone that has minor smoothing on a mildly concave surface, apparently the wear from use as a metate and/or anvil stone. Its dimensions are: L- 170 mm; W- 120 mm; T- 90 mm; its weight is 3397 gm.

The stone found with the metate/anvil is a fine-grained quartzite cobble of generally oblong to irregular shape (Fig. 5, D), with dimensions of 100 mm length, 74 mm width, and 45 mm thickness; its weight is 442 gm. It has extreme battering and some spalling from the thicker, wider end that was used most. A small, rounded point at the opposite end has light battering from minimal use. Overall, this damage is consistent with use as a hammerstone in flintknapping, the stone having the toughness of certain quartzites that is ideal for that purpose.

The fact that these two stones were found side-by-side (20 cm deep) suggests that they were cached, and possibly used in tandem. If so, this would be an unusual find of both kinds of stones needed for hammer/anvil (previously called bipolar) reduction of siliceous materials, which is known to have been practiced in the region.

However, the wear on the anvil stone is not consistent with wear expected from such rough useage. The wear is light and discontinuous smoothing with no signs of pitting or scarring from heavy impact.

The pitted stone is a large, rough block of ferruginous sandstone. A fairly soft, reddish brown sandstone, this specimen is 133 mm long, 115 mm wide, and 73 mm thick. The flatter of its two faces has some natural pitting, but some small pits are the result of use. There are three of the latter, which are roughly circular, 15-20 mm in diameter, and about 7 or 8 mm deep. The surface of these pits is not smooth. A larger pitted area appears to be mostly natural, but might have been used minimally.

The reverse face of the pitted stone is very irregular, but there is a concave area through the central portion that is smooth from use as a grinding stone. The wear overlaps over one edge which is rounded, and, on the other end, over both edges created by a corner of the stone. This wear is consistent with use as a metate, although the use area, approximately 70 X 120 mm, is comparatively small.

Table 3: Distribution of tools from shovel tests at 41CP229

DEPTH	ST-1	ST-4	ST-6	ST-7
0-10cm				
10-20cm		Gary Point		
20-30cm	Sherd	Flake Tool		
30-40cm		Biface Frag.		Biface
40-50cm				
50-60cm				
60-70cm			2 Biface Frags.	

Table 4: Artifact distribution in Gradall trenches at 41 CP229

DEPTH	GT-1	GT-2	GT-3	GT-17	GT-19	GT-28
Undetermined				Pot Sherd	Pitted Stone	
0-10cm						
10-20cm		Mano				Metate Hammerstone
20-30cm			2 Flakes			
30-40cm						
40-50cm	Mano					
50-60cm						
60-70cm	Flake					

## EXCAVATIONS AT 41CP228

The assessment of site 41CP228 appears to have been done somewhat beyond the site's margins. Due to the small size of the area, this work consisted of only three Gradall trenches and one shovel test (Fig. 6). These excavations (Table 5) were at the foot of the low hill upon which the site lies, and in the same area where previous negative shovel tests had been dug.

No cultural material was observed in the excavations or backdirt, but the surface could not be checked very well because of a thick growth of tall weeds and grass. There

did occur in GT 3 a lens of sandy matrix containing abundant charcoal and a partially burned stump, but there were no artifacts. This may have been an area where a large amount of brush was burned, perhaps in the earlier part of this century. Whatever the case, the charcoal-rich lens had been covered by 30 to 40 cm of colluvial slope wash. The small hill had been in cultivation continuously for many years until recently, and much sand and sandstone pebbles had washed from it.

Table 5: Dimensions of Gradall trenches and test pit.

SITE #41CP228				
PIT #	LENGTH	WIDTH	DEPTH	REMARKS
G1	6.7 m	3.7 m	0.9 m	
G2	4.6 m	1.8 m	0.6 m	
G3	3.7 m	1.8 m	1.1 m	
S1	0.7 m	0.7 m	0.9 m	

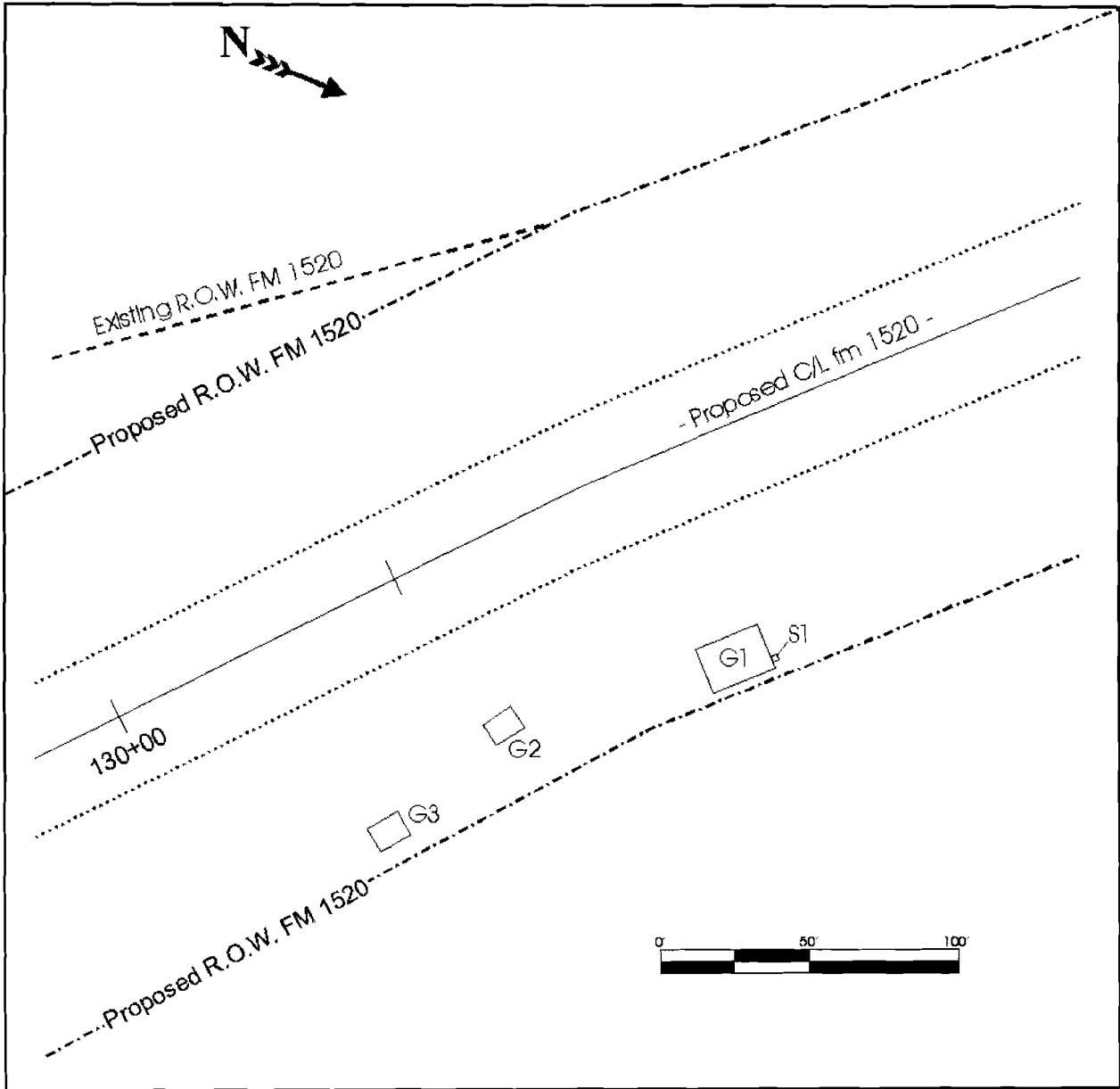

Figure 6: Location of Gradall trenches and shovel tests at 41CP229.

## ASSESSMENT AND RECOMMENDATIONS

Site 41CP229 is a large area of prehistoric activity, only a portion (160 X 800 ft. strip) of which occurs within the proposed right-of-way. According to local informants, the most productive part (in terms of collectable artifacts) lies to the east of the project. This area lies nearer to the confluence of Walkers Creek and its tributary to the north, which runs beside 41CP228. Therefore, it would be reasonable to expect a more abundant artifact assemblage (among other cultural materials) in the described area.

The part of the site within the proposed right-of-way, which was probed with a goodly number of excavations, was productive neither in terms of artifacts nor features. Only one of several anomalies found is thought to possibly be a prehistoric feature, and it apparently is an isolated find lacking meaningful context. No artifacts or other clues were found which could immediately place it in time. It did contain charcoal, but, without context,

radiocarbon dating would be a useless exercise.

After a close look at the site, it is determined that the part of 41CP229 within the proposed right-of-way is insignificant and does not merit further work.

The area of the proposed project that runs near site 41CP228 was much smaller and much easier to access. If the western margin of this site does extend into the project area, it is so sparsely represented that no cultural material has yet been found. From viewing the condition of site 41CP228, it is unlikely that whatever part of it lies within the old field retains any significance, and there is certainly no evidence that anything of significance lies within the project area.

The proposed project, then, appears to only skirt site 41CP228, contains no significant cultural material, and does not merit further work.

## REFERENCES CITED

- Blair, W. F.  
1950 The Biotic Provinces of Texas. *Texas Journal of Science* 2: 93-117
- Bureau of Economic Geology  
1966 Geologic Atlas of Texas; Texarkana Sheet.
- Carr, J. T.  
1967 The Climate and Physiography of Texas. Report 53; Texas Water Development Board, Austin, Texas.
- Perttula, Timothy K.  
1996 Personal communication with the author in October 1996.
- Sellards, E. H., W. S. Adkins, and F. B. Plummer  
1932 The Geology of Texas. Bulletin 3232. The University of Texas at Austin.
- Story, Dee Ann  
1981 An Overview of the Archaeology of East Texas. *Plains Anthropologist* 26: 139-156.
- United States Department of Agriculture Soil Conservation Service  
n.d. Soil Survey of Camp County, Texas.
- Young, Wayne  
1981 Test Excavations at the Tankersley Creek Site, Titus County, Texas. SDHPT Report No. 22, Austin, Texas.